

Join the Excellence

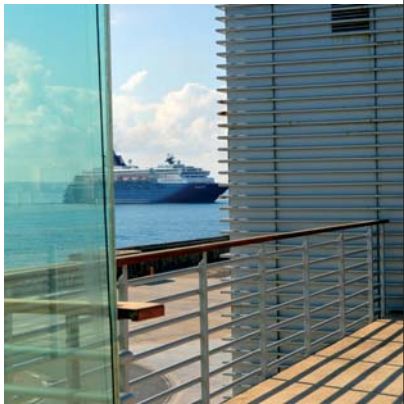

ALICANTE
CRUISE TERMINAL





The Port of Alicante
strategically located
and linked



NAVIGATION RANGE FROM ALICANTE

Alicante to Barcelona
Distance: 229 nautical miles
Travel Time: 12 hours at 19 knots

Alicante to Palma de Mallorca
Distance: 174 nautical miles
Travel Time: 9 hours at 19 knots

Alicante to Málaga
Distance: 252 nautical miles
Travel Time: 12 hours at 21 knots

GEOGRAPHICAL LOCATION & CLIMATE

Alicante
Longitude 0°30'W
Latitude 38°20'N

With a privileged geographical location the Port of Alicante is an ideal Spanish cruise destination.

The Port of Alicante is located at 0° 30'W longitude and latitude 38° 20'N, only one night cruise from the main Spanish ports in the Mediterranean: Barcelona 229 miles, Málaga 252 miles and Palma de Mallorca 174 miles.

Alicante is considered Europe's Sunbelt and enjoys a mild Mediterranean climate all year round with about 2,800 hours of sunshine and an average temperature of 18.3°C (65°F).



INCREASING CRUISE TRAFFIC



Cruise Calls in Alicante

Alicante Cruise Terminal is stepping up its efforts and has implemented a new strategy to increase its number of cruise calls. This has already resulted in a significant raise in the upcoming number of cruise calls and also in the number of passengers arriving in increasingly larger cruise ships.

Since 2014 the number of cruise calls has increased with nearly 72% and the number of passengers with 153%. The numbers for 2015 are confirmed to date.



PASSENGERS

			
Year	2013	2014	2015
No.	38,768	34,583	87,434 (Confirmed to date)

CALLS

			
Year	2013	2014	2015
No.	32	29	50 (Confirmed to date)



EXCELLENT TRANSPORT CONNECTIONS

High Speed Train (AVE) Alicante/Elche International Airport

Alicante is well communicated at both national and international level. Alicante/Elche International Airport is situated 12 kilometres from the cruise terminal, and by car the train station is only 5 minutes away.

The airport currently receives more than ten million passengers and its facilities can accommodate twenty million passengers yearly. Recently a High Speed Railway Line (AVE) to Madrid has been launched with a time of 2 hours and nine daily trains.





Facilities and technical features of the Cruise Port



















i BERTHING INFORMATION AND TECHNICAL FACTS

- Name of quay: Muelle 14
- Longitude 0° 30' W
- Latitude 38° 20' N
- Open: 24 hours
- Terminal surface 5,400sqm
- Quay length: 970m
- Maximum length of ship: Unlimited
- Maximum draft of vessel: 14m
- Maximum height of ship: Unlimited
- Width of berth: 60m
- Height of berth from sea level: 1.5m
- Finger available
- Number of available tugs: 2
- Boatmen available
- Stevedores available
- Customs Office
- Arrival/departure time restrictions: none
- Pilots compulsory
- Compliance with ISPS Regulation 2002
- Distance to city centre: 1km



SERVICES

	Air conditioning		Free WIFI
	Information desk		Parking
	Taxi		Shuttle bus
	Toilets		Lifts
	Metal detector		Coffee/Bar
	Check-in counters		Stairs
	Security control		Escalator
	Waiting area		Luggage handling
	First aid & assistance to PRM		Shops

FIRST FLOOR

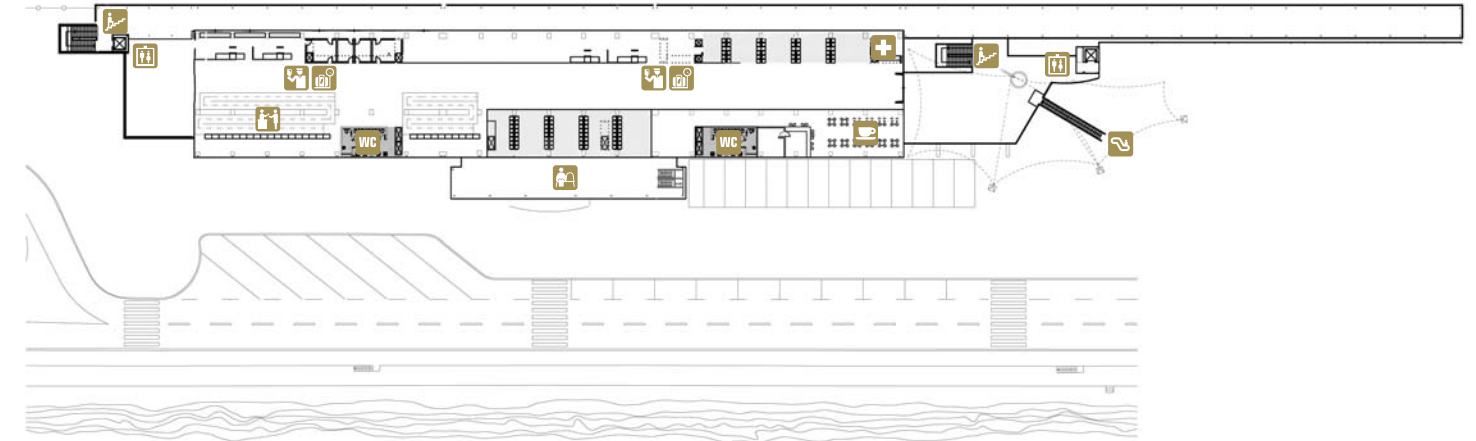

GROUND FLOOR

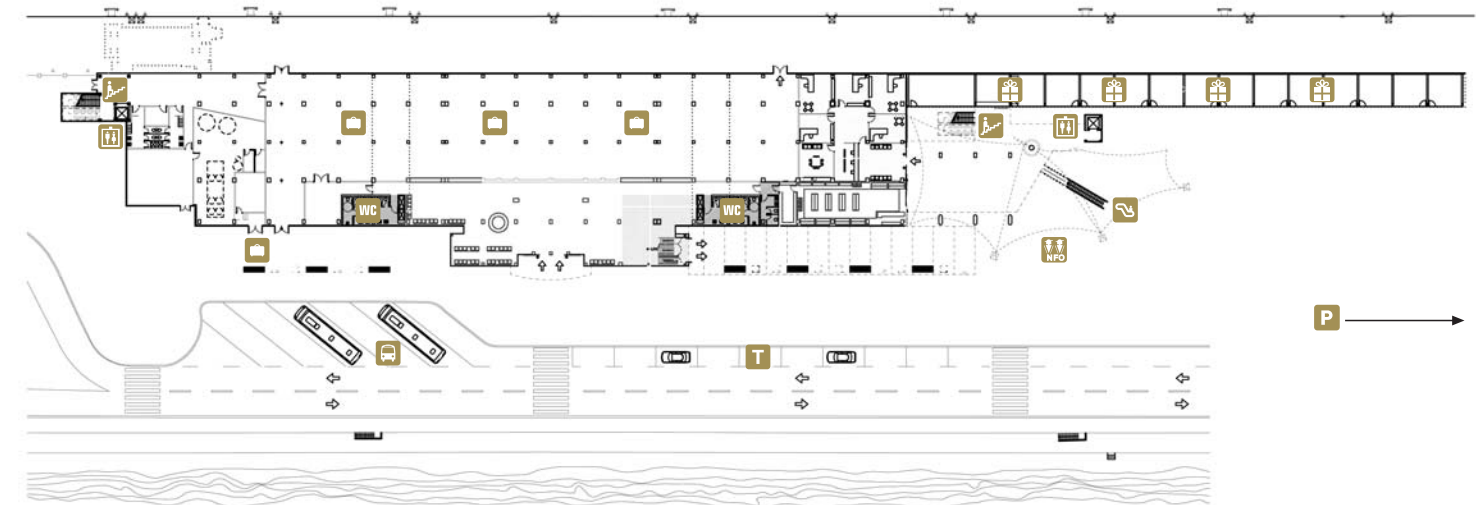



Alicante
the Mediterranean
essence



CRUISE PORT IN THE HEART OF THE CITY

Few cities in the world have their port in the city centre- Alicante is one of them.

It is a delight to visit Alicante with its traditions as ancient as Europe.

Alicante offers wonderful views, attractions and places to visit. Walks, beaches, shopping and leisure centres are spread along the sea route and around the terminal. It is a pleasure for the five senses to enjoy the beaches, parties or cuisine in Alicante and also an unforgettable vacation.

Cruise passengers have the possibility to pre-book bus excursions before coming to Alicante or to visit the city and surroundings on their own. They can walk, take the shuttle bus or a taxi from the pier to the city.

For the complete cruise vacation, give Alicante a try and see what the city and the area have to offer you!



TOURIST MAP OF ALICANTE

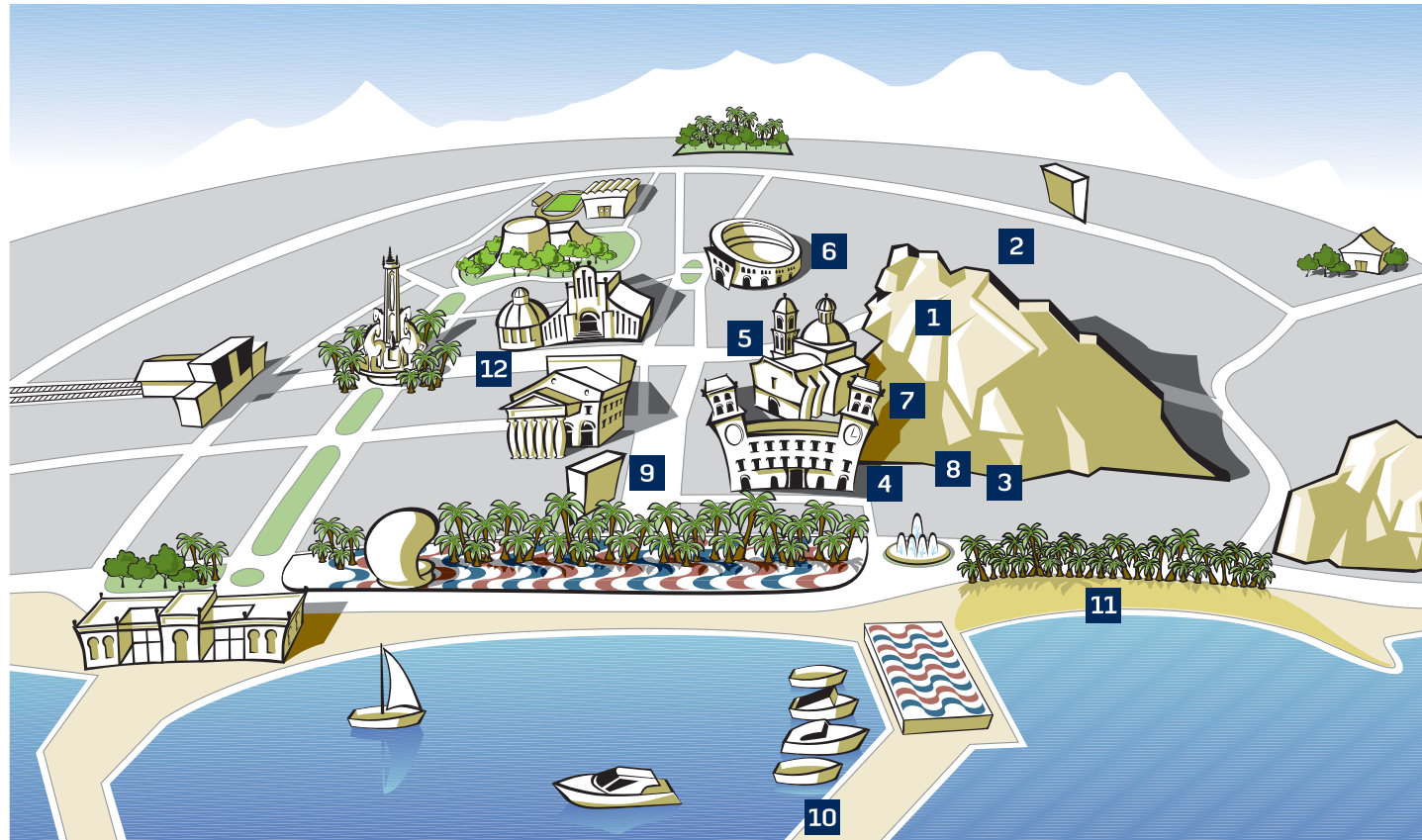

- | | |
|--|-------------------------------------|
| 1 Castle of Santa Barbara | 7 EL Barrio |
| 2 MARQ is the archaeology & history museum | 8 Museum of Contemporary Art (MACA) |
| 3 Santa María Basilica | 9 Fogueres Festival Museum |
| 4 Town Hall | 10 Volvo Ocean Race Museum |
| 5 Co-cathedral of Saint Nicholas | 11 Beaches |
| 6 Bullfighting Museum | 12 Central Market |

ALICANTE OVER 7,000 YEARS OF HISTORY & CULTURE

Alicante Province is located on the south east coast of Spain also known as Costa Blanca. During the years Alicante Province has become one of the main tourist destinations in Spain and even in Europe. Its capital is Alicante and it is a medium-sized city.

Alicante city was founded as an Iberian colony in 5000 BC and was captured in 201 BC by the Romans, who called it Lucentum. After being ruled by the Moors (718-1249), it was later incorporated into the kingdom of Aragón in 1265. The city was besieged by the French in 1709 and by the Federalists of Cartagena in 1873.

The provincial economy is based on tourism and its rich industrial sector.

Tourism Highlights

- 3 UNESCO World Heritage Declarations.
- 6 "Fiestas" declared of International Tourist Interest.
- 6 Designations of Origin (D.O.) related to gastronomy.
- Renowned Museums.
- 9 Nature Reserves /Natural Parks.
- 30 quality yacht clubs and 22 Golf Courses most of which are located along the sea.
- Extensive quantity and variety of beaches (134 in total of which 27 have access for the disabled).

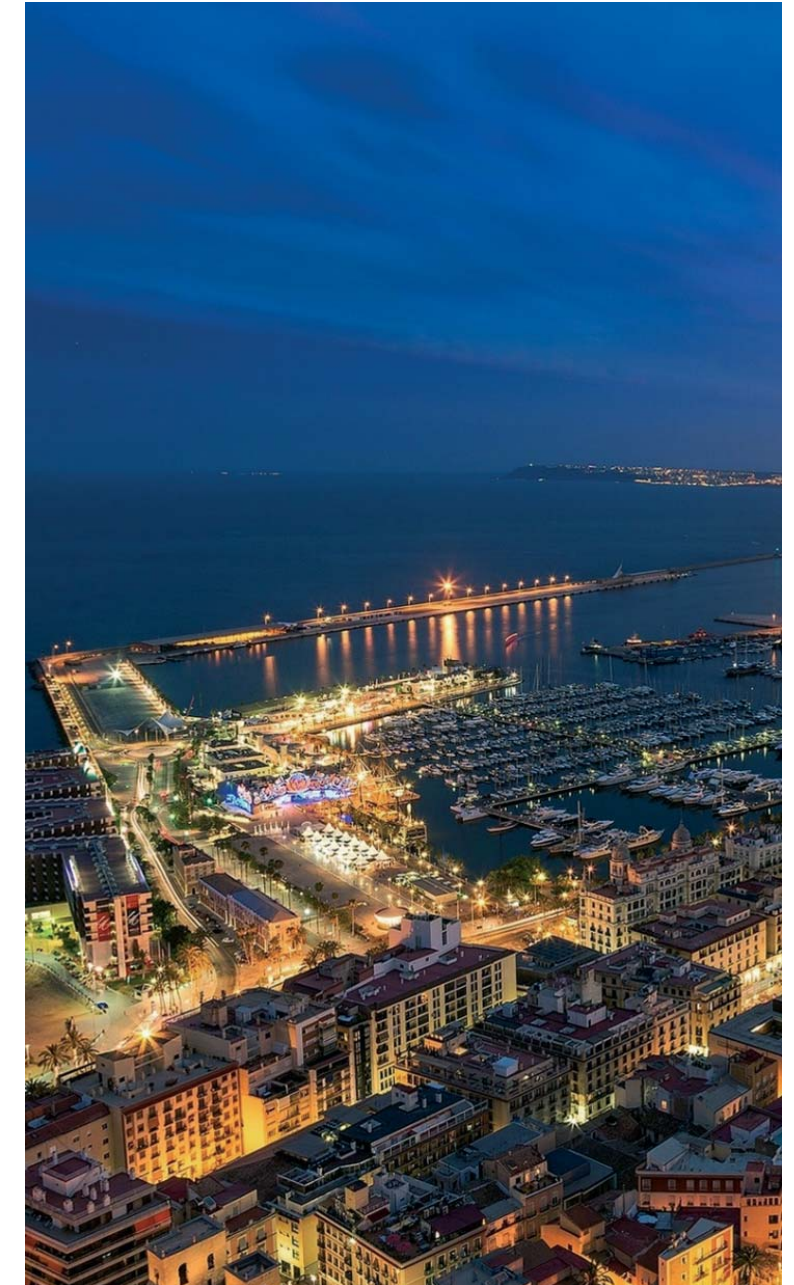

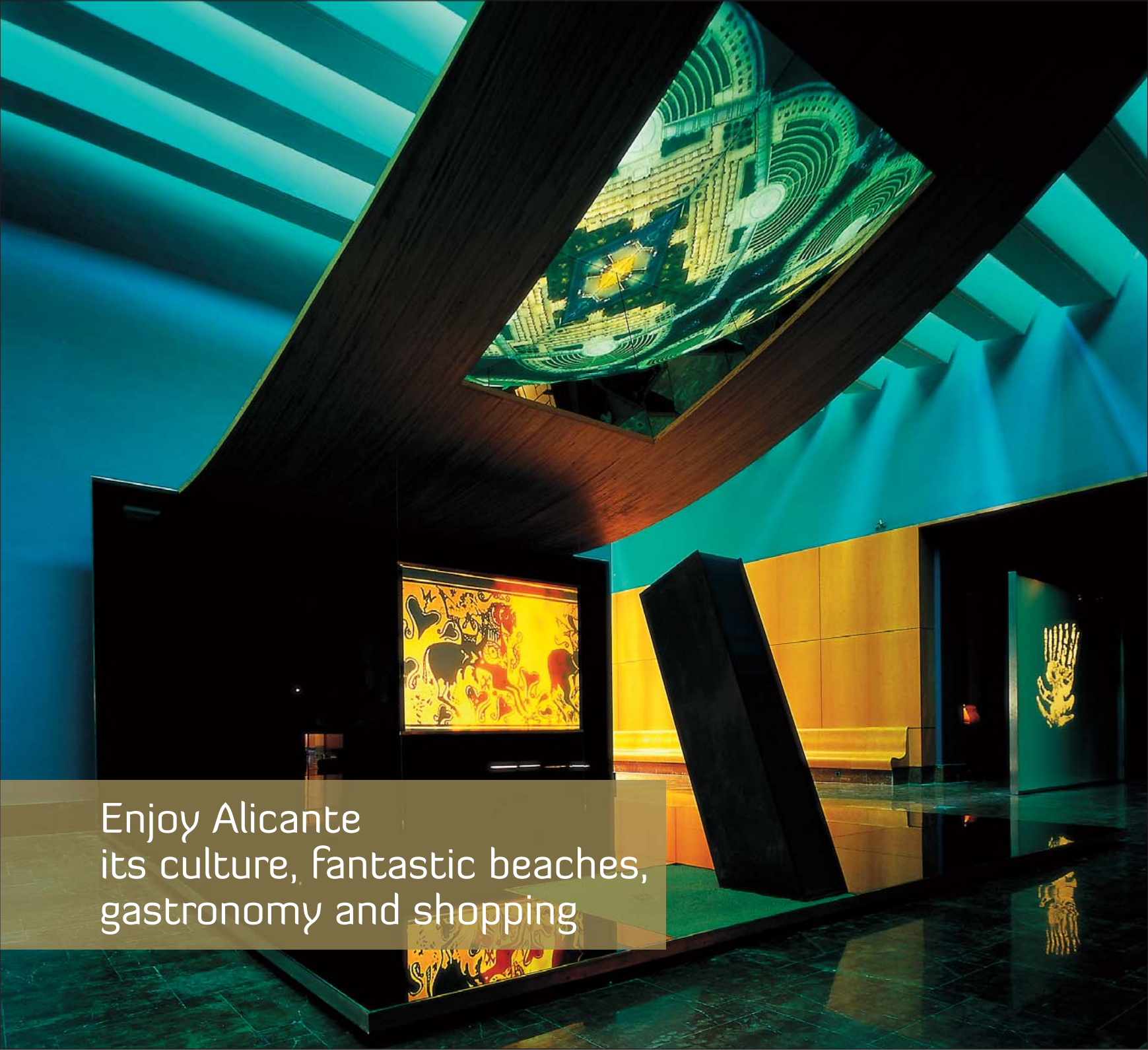

Enjoy Alicante
its culture, fantastic beaches,
gastronomy and shopping

PLACES OF INTEREST

As the Cruise Terminal of Alicante is situated in the city centre it allows fast and easy access to the main tourist attractions.



The Castle of Santa Barbara is an impressive castle overlooking Alicante City.

It's one of the largest medieval fortresses in Europe and covers the complete summit of the Benacantil Mountain.



The Co-cathedral of Saint Nicholas of Bari is from the 17th century and it is built in the Herrerian renaissance style.



The Town Hall is a baroque style palace dating from the 18th century. You will experience the remarkable rooms such as the Salón Azul (Blue Room) from the period of Queen Isabel of Spain.



The Santa María Basilica is the oldest church in the city from the 13th and 16th century and it is built in Gothic Style.



El Barrio is the old quarter of Alicante. It is a very popular place, especially at night. People of all ages go to el Barrio to enjoy the many pubs, bars and taverns. During day time it is a nice place to go for a walk and enjoy the beauty of the architecture.

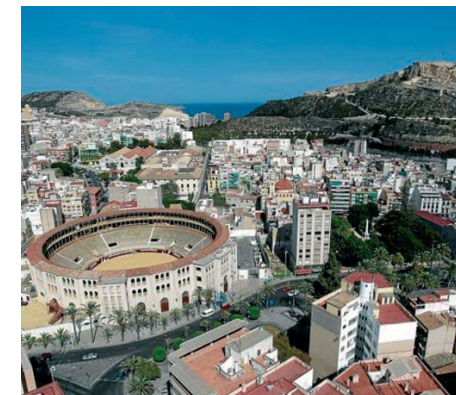

The Ibero-Roman City of Lucentum is an archaeological site that covers an area of some 30,000m². It was found on the hill known as Tossal de Manises in the 18th century.



The Bullfighting Museum houses a permanent exhibition of Alicante's bullfighters.



The MARQ is the archaeology & history museum. The MARQ was granted the Best European Museum Award in 2004.

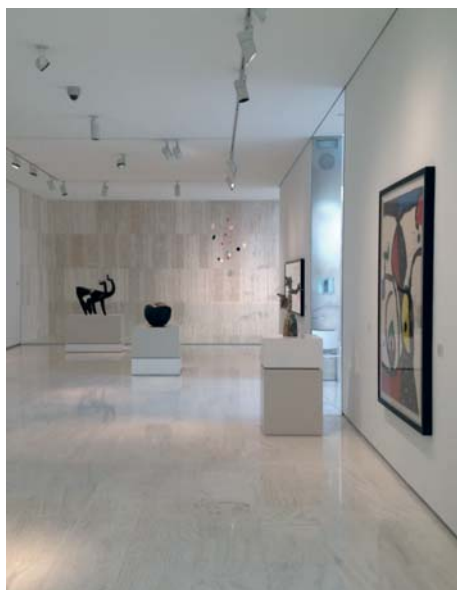

The Museum of Contemporary Art (MACA) is one of the oldest buildings in Alicante from 1687. In MACA you can see paintings by Dali, Cocteau, Miro, Bacon and Picasso.



The Fogueres Festival Museum focuses on the most popular festival of the city, the Bonfires of San Juan.



The Volvo Ocean Race Museum gives you a chance to learn about the famous round-the-world sailing race. Alicante is serving as the port of departure. This is the only museum in the world that specializes in the most demanding challenge to sailors of our time.



Beaches. One of Alicante's main tourist attractions are the fantastic beaches with its high quality water and sand. The best known beaches in the area closest to the Cruise Terminal are Playa Postiguet, situated right in the city at the foot of Mount Benacantil and opposite the Santa Barbara Castle, la Albufereta, located to the north-east of the city and Playa San Juan which is Alicante's best known beach with fine, golden sand. It measures some seven kilometres in length and almost 100 metres in width. Both Albufereta (4km) and San Juan (8km) can be reached by bus or tram from the city centre. These beaches are awarded blue flag beaches.



The culture
of paella & tapas



LOCAL CUISINE, DRINKS & TAPAS

Alicante Province has become an important reference in gastronomy and in 2014 the cuisine was awarded with 9 Michelin stars.

Alicante has a wide range of restaurants and cafés scattered around the city. These offer both international and local Spanish cuisine ranging from paellas, seafood dishes, stews, meat and vegetables accompanied with local beers and Alicante wines. In addition there is a wide variety of fruit, bakery, pastries, ice-cream and sweets (chocolate and nougat/turrón).

Alicante is the land of paella and sangría. The many tapas bars in Alicante offer a great variety of dishes and local delights. The story says that the origins of tapas started in Alicante, called Montaditos which are small delicacies served on a crusty bread. These eventually became the tapas we know today and are served worldwide.



SHOPPING

Alicante City is a shopper's paradise with opening hours stretching into the early evening.

There is a wide range of shops in Alicante, several shopping centres and shopping streets where you can find international and Spanish brands as well as products that are typical of the region, for instance:

- Famous quality leather goods: shoes, bags and accessories
- Toys and dolls
- Gastronomic products: wines, table grapes, olive oil, chocolate, dates, nougat and ice-cream
- Potteries and ceramics

LOCAL CURRENCY

The local currency is the euro. Major credit cards are usually welcomed and there are plenty of ATMs in Alicante.



The pleasure
of shopping



OPEN AIR ACTIVITIES & SPORTS

Alicante City and Province offer a great selection of possibilities regarding open air activities and sports such as all types of water and beach sports, golf, nature and adventure sports. All reachable within just one hour ratio.



FESTIVALS

Take part in Alicante's festivals and discover a whole world of emotions. The festivals are certainly one of the greatest attractions this warm and welcoming Mediterranean city has to offer.

Main events: Carnival in February or March, Holy Week - Easter in March or April, the popular Pilgrimage of the Holy Visage to Santa Faz Sanctuary in April or May, Moors and Christians held throughout the year, in July, August and December, the Hogueras de San Juan (bonfires) from 20th to 29th of June, the Mediaeval Market in the end of June or first week of July and the Mystery Play of Elche in August.

The Hogueras de San Juan is one of the most important events in Alicante City. This festival is held in June and has been officially declared to be of International Tourist Interest and its origins lie in the tradition of burning objects with the arrival of the summer solstice.

The Moors and Christians are the most important festivals in the Province of Alicante held throughout the year, in July, August and December

The Mystery Play of Elche (10km from Alicante City) is a chanted drama of mediaeval origins which traces the dormancy, the assumption to the skies and the crowning of Virgin Mary. In 2002 it was included in the list of UNESCO Masterpieces of Oral and Intangible World Heritage.



BEYOND ALICANTE Ideal for excursions

Cruise passengers arriving in Alicante have the opportunity to get to know the city and its province thanks to the exiting and high quality tours.

Our aim is to show and share the richness of our area to make it the preferred destination for visitors and to engage them to come back.

The excursions, both original and innovative, include history and culture, nature, gastronomy and shopping.

Do not miss the opportunity to hike in natural parks, visit UNESCO World Heritage sites, castles and charming towns, shop at popular shoe outlet stores or taste high quality local wines and extra virgin olive oil.

All this richness has positioned Alicante Province as one of the top preferred and recurrent destinations for visitors in Europe year after year.

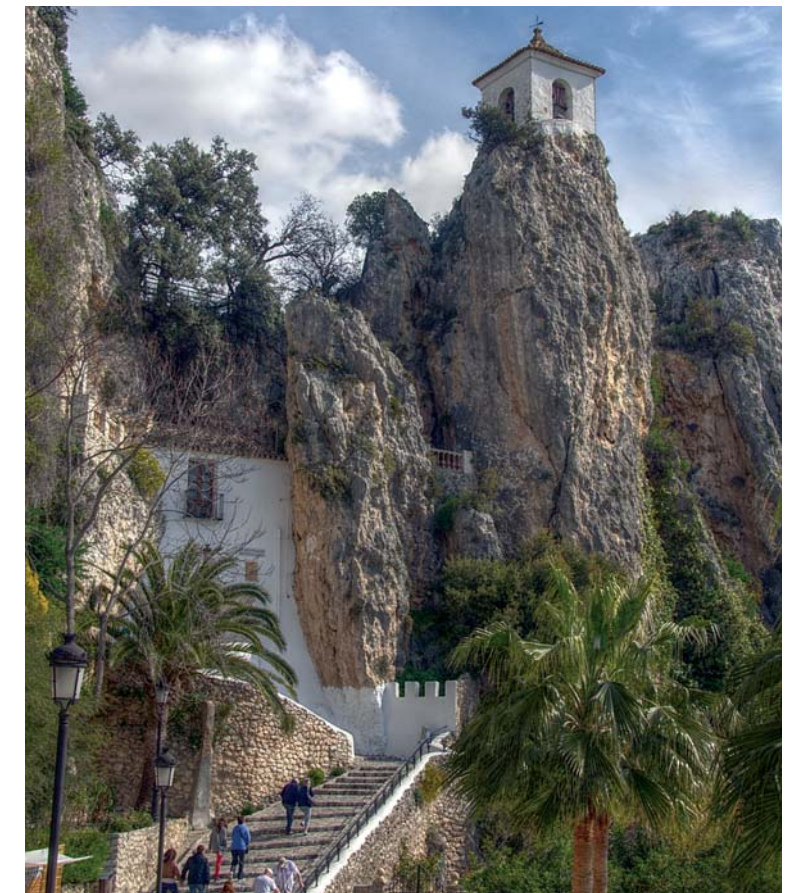

USEFUL CONTACTS

PORT SERVICES & OTHER

- PORT AUTHORITY**
Tel. +34 965 130 095
- PORT POLICE**
Tel. +34 965 130 140
- EMERGENCY PORT**
Tel. +34 965 131 101
- HARBOUR MASTER**
Tel. +34 965 923 770
- NATIONAL POLICE**
Tel. +34 965 209 544
- CIVIL GUARD**
Tel. +34 965 211 761
- S.A.M.U. (Medical Assistance)**
Tel. +34 965 971 775
- HOSPITAL PERPETUO SOCORRO - VITAS**
Tel. +34 965 201 100
- HOSPITAL INTERNACIONAL MEDIMAR**
Tel. +34 965 162 200
- HOSPITAL VISTAHERMOSA**
Tel. +34 965 264 200
- PORT PILOTS**
Tel. +34 965 211 137
UHF 156.80 (Chn 16)
- MOORING**
Tel. +34 965 216 575
- TUGS**
Tel. +34 963 675 257

SHIPPING AGENTS

- ALICANTE PORT S.L**
Tel. +34 965 230 544
- ALVARO A RODRIGUEZ SANCHEZ**
Tel. +34 965 710 439
- BERGE Y CIA S.A.**
Tel. +34 965 133 874
- CESA ALICANTE S.A**
Tel. +34 965 141 509
- FERNANDO FLORES S.L.**
Tel. +34 965 218 300
- BOLLORÉ AFRICA LOGISTIC SPAIN S.A.U.**
Tel. +34 965 144 728
- JSV LOGISTIC S.L.**
Tel. +34 965 102 229
- MARITIMA DEL MEDITERRANEO S.A.**
Tel. +34 965 142 310
- MILLER Y CIA S.A.**
Tel. +34 965 122 800
- OPERADORES PORTUARIOS STA. POLA**
Tel. +34 965 230 544
- PEREZ Y CIA S.L.**
Tel. +34 965 141 765
- PORTCARGO ALICANTE S.L.**
Tel. +34 965 144 043
- RODACO HISPANIA S.L.**
Tel. +34 966 104 900
- ROMEU Y CIA S.A.**
Tel. +34 965 141 509
- TRÁNSITOS ADUANEROS DE ALICANTE S.L.**
Tel. +34 965 085 929
- TMS ALICANTE**
Tel. +34 965 984 923
- TRANSCOMA**
Tel. +34 965 209 033





Muelle 14, Port of Alicante, 03001 – Alicante (Spain)
T. +34 966 271 693
info@cruisealicante.com
www.cruisealicante.com



Join the Excellence

